

Step A- Remove trim from housing



Step B- Remove lamp assembly.
*Make sure to shut-off power to fixture.



Step C- With power off, disconnect lamp assembly.



Step D- If possible, lay fixture on a flat surface reflector side up, to prevent pieces from falling out when disassembled.

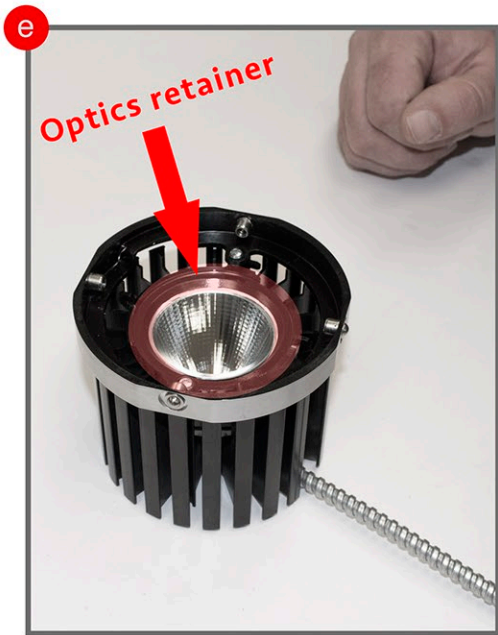

Step E- Locate Optics Retainer (Highlighted in red is the ring that holds the reflector in place).



Step F- Turn Optics Retainer counter-clockwise till piece comes loose.



Step G- Remove Optical Retainer and then remove reflector.

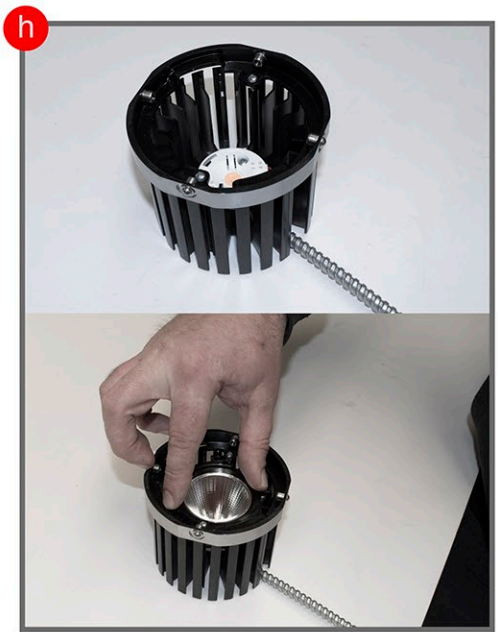

Step H- Install new reflector and optics retainer. Re-install into plaster ceiling.



**Optical Replacement for
Graffiti Fixed
Instruction Sheet for
GRF, GR, GRO
Series**

