

Light efficiency:



Output: 928 lm

Light quality:



Peak: 3088 cd

Power: 21.3 W



Beam angle

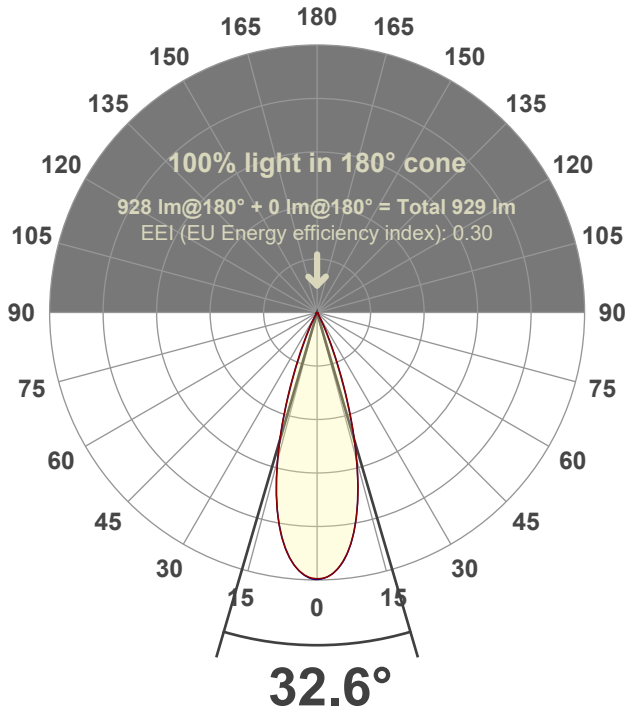

Test number:

GR-F-F-A20-3019-FL-SQ-91A-Rev2

Luminaire Model:

Graffiti Flat Square Fixed Downlight-A20-3019 38° Optic-Solite

Date and time:

6/21/2022 8:12:46 PM

Delivered Lumens

928

Spectra

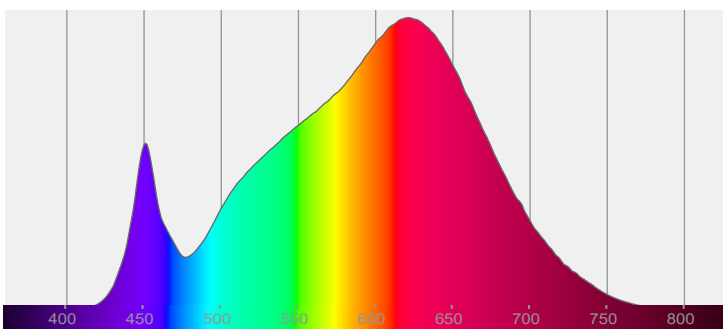

CRI: 92.9 (R1-R8)

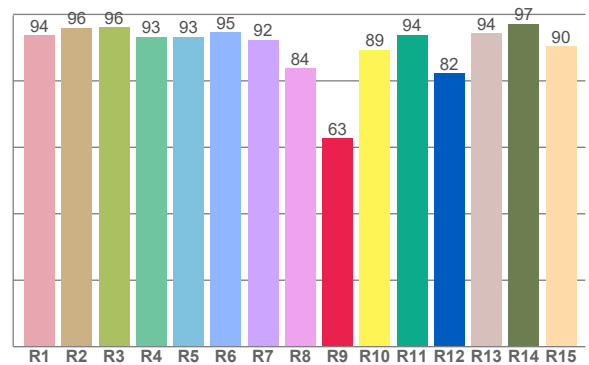

Color parameters

	Color rendering index	Red component	Color fidelity	Color gamut	Color quality scale	Color coordinate cie 1931	Color coordinate cie 1931	Color coordinate	Color coordinate	Color deviation from black body
	CRI	CRI R9	TM30 R _f	TM30 R _g	CQS	x	y	u	v	Δuv
	92.9	62.8	91.1	101.6	89.9	0.434	0.397	0.252	0.346	-0.0023

R_f 91.1
Fidelity index R_f

R_g 101.6
Gammut index R_g

TM30: 91.1

TM-30Color

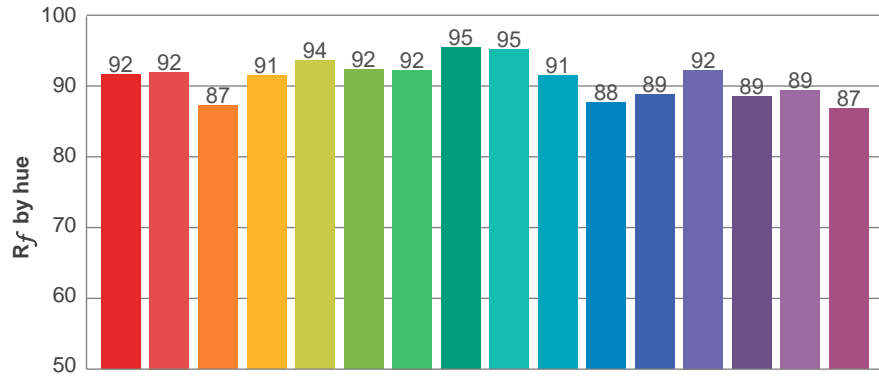

Hue Bin	R_f	Graphic shifts (%)	
		Chroma	Hue
1	92	-4%	-1%
2	92	-3%	3%
3	87	-1%	7%
4	91	1%	4%
5	94	4%	4%
6	92	5%	-1%
7	92	1%	-4%
8	95	0%	-3%
9	95	-2%	0%
10	91	-2%	5%
11	88	0%	9%
12	89	5%	3%
13	92	5%	-3%
14	89	6%	-7%
15	89	1%	-7%
16	87	-1%	-11%

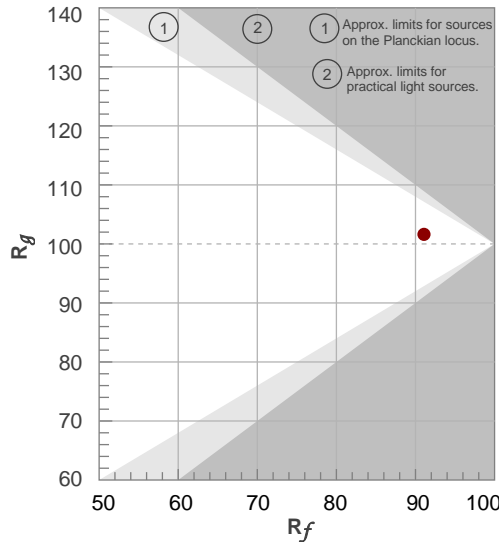

Color vector graphics

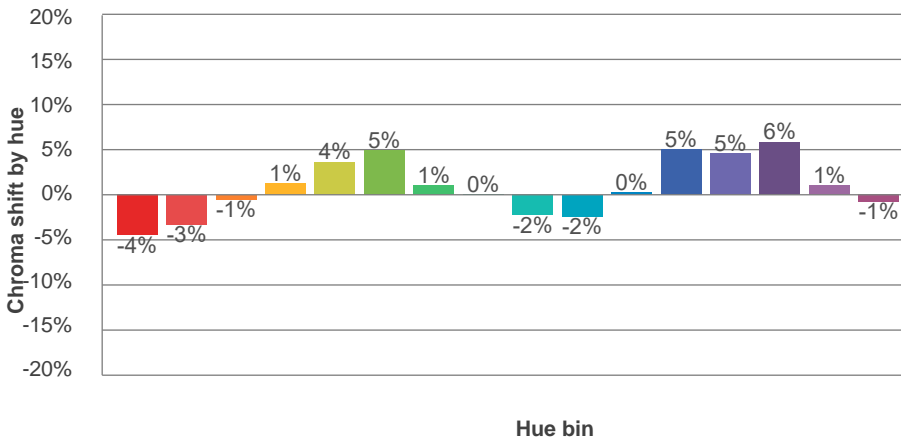
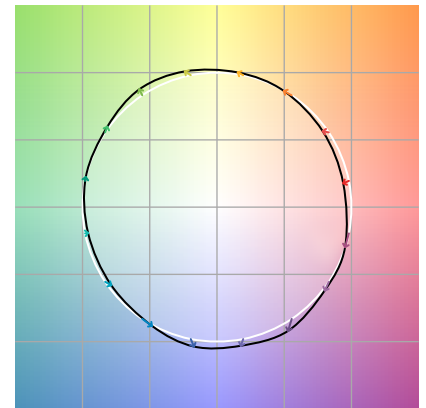

Color distortion

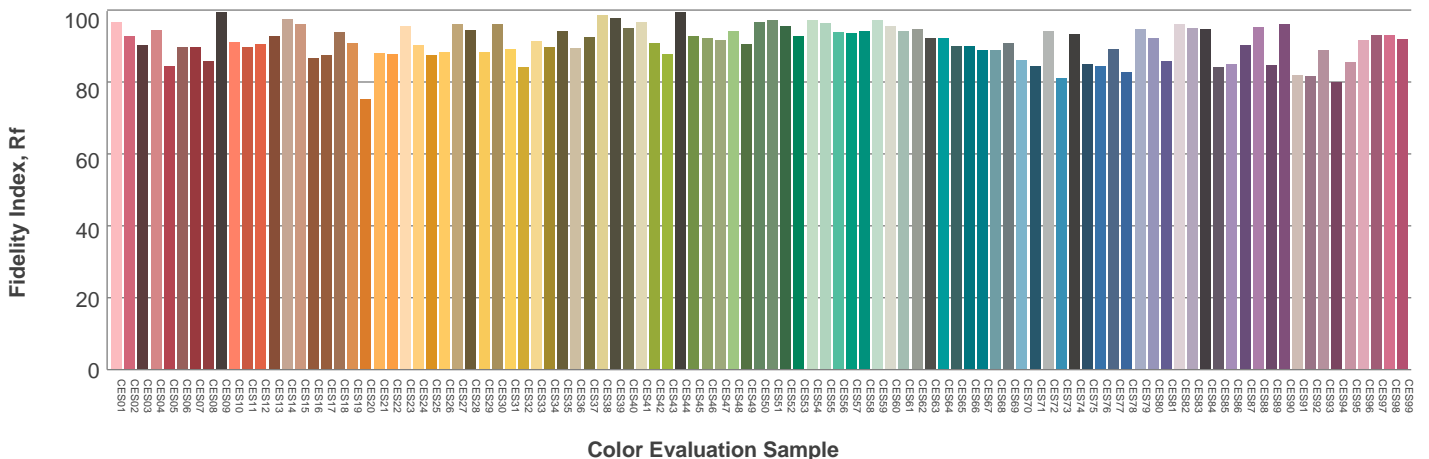
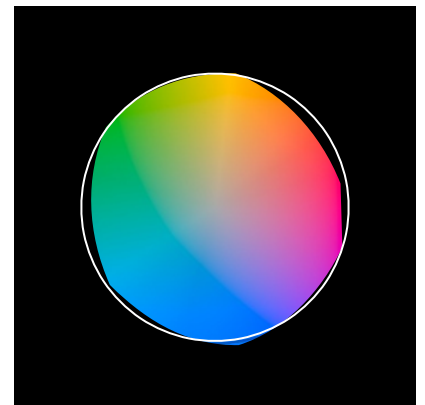

Beam details

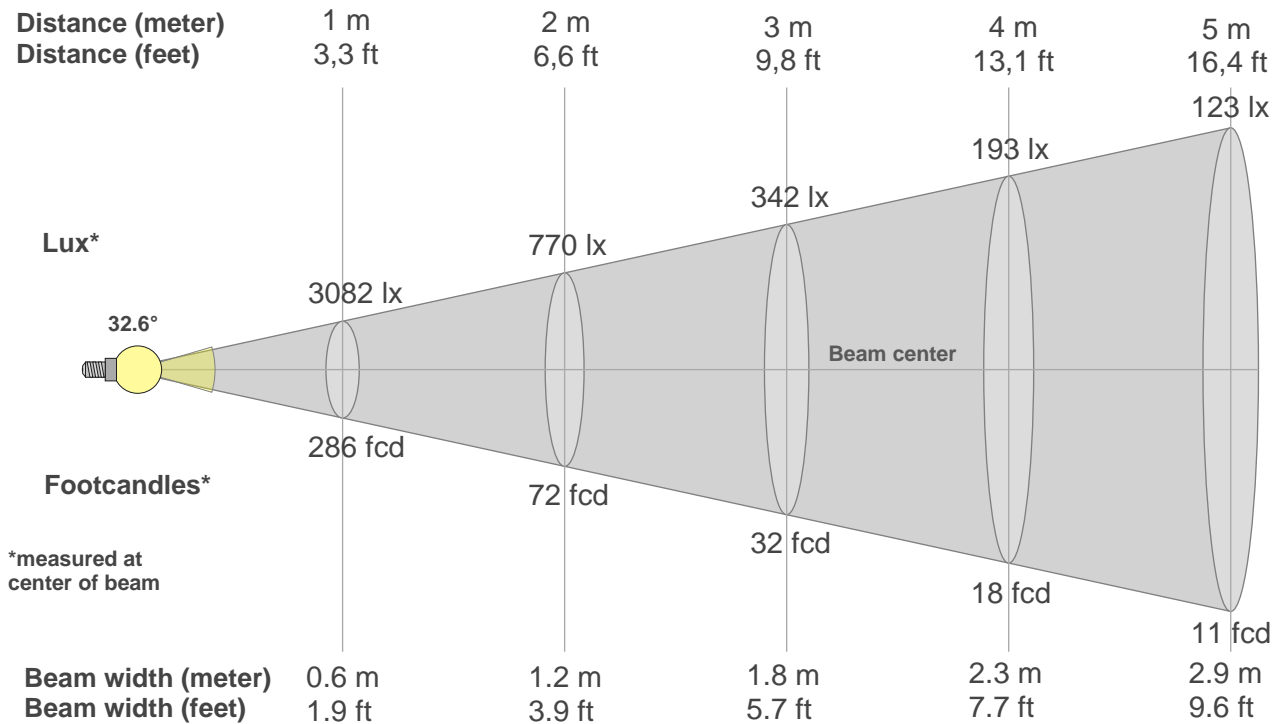

Beam intensities from 1-20m

1m	2m	3m	4m	5m	6m	7m	8m	9m	10m	11m	12m	13m	14m	15m	16m	17m	18m	19m	20m
3.3ft	6.6ft	9.8ft	13.1ft	16.4ft	19.7ft	23ft	26.2ft	29.5ft	32.8ft	36.1ft	39.4ft	42.7ft	45.9ft	49.2ft	52.5ft	55.8ft	59.1ft	62.3ft	65.6ft
3082lx	770lx	342lx	193lx	123lx	86lx	63lx	48lx	38lx	31lx	25lx	21lx	18lx	16lx	14lx	12lx	11lx	10lx	9lx	8lx
286.3fcd	71.6fcd	31.8fcd	17.9fcd	11.5fcd	8fcd	5.8fcd	4.5fcd	3.5fcd	2.9fcd	2.4fcd	2fcd	1.7fcd	1.5fcd	1.3fcd	1.1fcd	1fcd	0.9fcd	0.8fcd	0.7fcd

Intensities in 0° c-plane

0°	2°	4°	6°	8°	10°	12°	14°	16°	18°	20°	22°	24°	26°	28°	30°	32°	34°	36°	38°
3082	3060	2996	2886	2732	2522	2254	1942	1603	1255	912	623	405	248	142	78	47	29	18	13
100%	99%	97%	94%	89%	82%	73%	63%	52%	41%	30%	20%	13%	8%	5%	3%	2%	1%	1%	0%

Intensities in 90° c-plane

0°	2°	4°	6°	8°	10°	12°	14°	16°	18°	20°	22°	24°	26°	28°	30°	32°	34°	36°	38°
3082	3064	3006	2892	2727	2511	2248	1942	1591	1227	882	582	347	194	109	60	34	22	15	11
100%	99%	98%	94%	89%	81%	73%	63%	52%	40%	29%	19%	11%	6%	4%	2%	1%	1%	0%	0%

Intensities in 180° c-plane

0°	2°	4°	6°	8°	10°	12°	14°	16°	18°	20°	22°	24°	26°	28°	30°	32°	34°	36°	38°
3082	3061	2991	2879	2719	2512	2254	1941	1602	1254	919	624	408	257	154	87	48	29	19	14
100%	99%	97%	93%	88%	82%	73%	63%	52%	41%	30%	20%	13%	8%	5%	3%	2%	1%	1%	0%

Intensities in 270° c-plane

0°	2°	4°	6°	8°	10°	12°	14°	16°	18°	20°	22°	24°	26°	28°	30°	32°	34°	36°	38°
3082	3060	2992	2883	2717	2503	2242	1936	1593	1229	878	583	357	204	111	64	38	24	16	11
100%	99%	97%	94%	88%	81%	73%	63%	52%	40%	29%	19%	12%	7%	4%	2%	1%	1%	1%	0%

Beam angle 50%	Field angle 10%	Cutoff angle 2,5%	Intensity ratio in 120° cone	Intensity ratio in 90° cone
32.6°	49.7°	59.5°	98.5%	98.0%

LAMPS (number of lamps)
50

Light planning Luminaire budgetary diagram

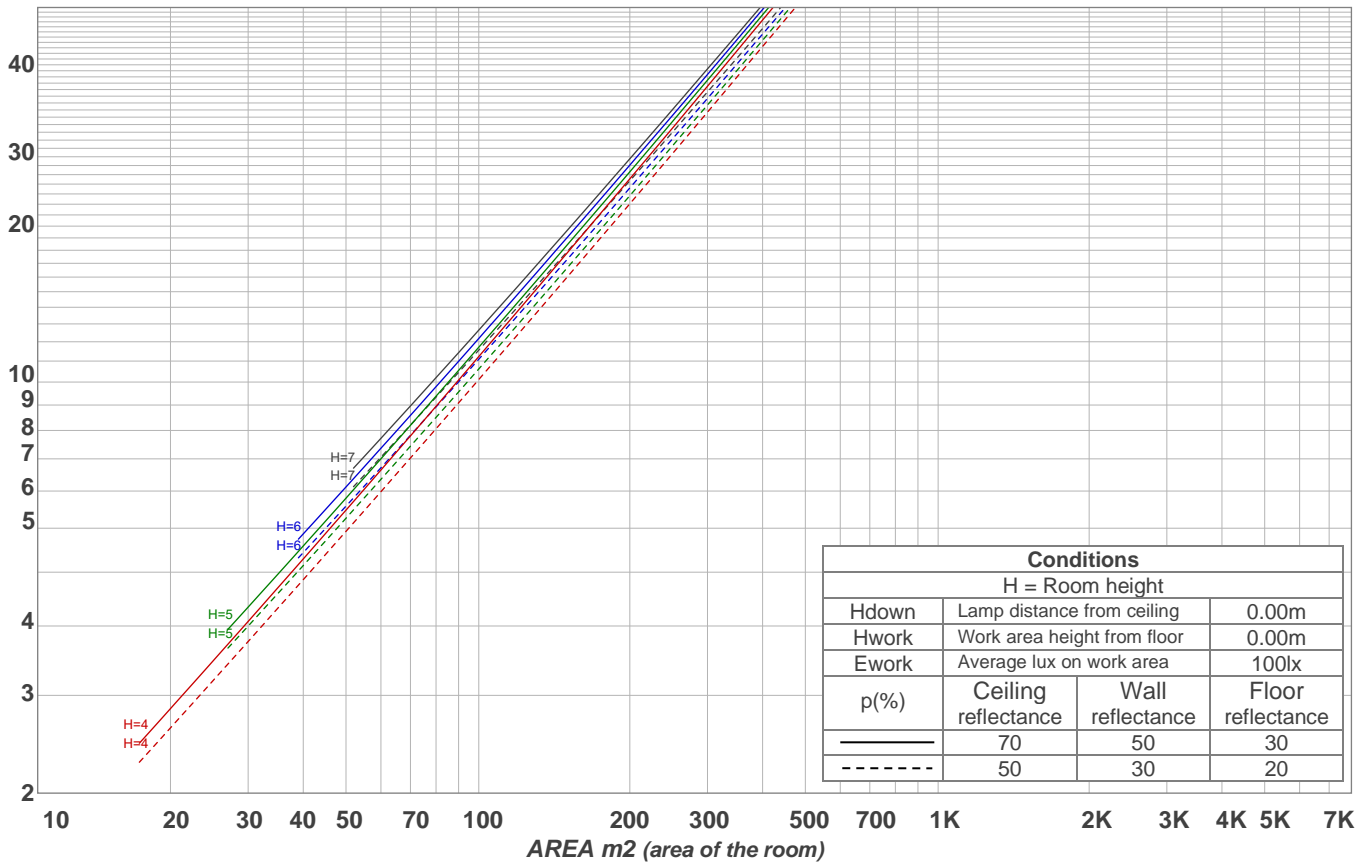

Luminaire budgetary diagram AREA m2 (area of the room) Coefficients of Utilization

Ceiling reflectance	80				70				50			30			10			0			
Wall reflectance	70	50	30	10	70	50	30	10	50	30	10	50	30	10	50	30	10	50	30	10	0
Floor reflectance	20	20	20	20	20	20	20	20	20	20	20	20	20	20	20	20	20	20	20	20	0
RCR	(RCR: Room Cavity Ratio)																				
	Room Values are expressed as percentage of Lumens delivered to the task surface																				
0	119	119	119	119	116	116	116	116	111	111	111	106	106	106	102	102	102	100	100	100	
1	115	112	110	108	112	110	108	107	106	105	103	103	101	100	99	98	97	96	96	96	
2	111	107	104	101	109	105	102	100	102	100	98	99	97	96	96	95	94	92	92	92	
3	107	102	98	95	105	101	97	94	98	95	93	96	94	92	94	92	90	89	89	89	
4	103	98	94	90	102	97	93	90	95	92	89	93	90	88	91	89	87	86	86	86	
5	100	94	90	87	99	93	89	86	92	88	85	90	87	85	89	86	84	83	83	83	
6	97	91	86	83	96	90	86	83	89	85	82	87	84	82	86	83	81	80	80	80	
7	94	88	83	80	93	87	83	80	86	82	80	85	82	79	84	81	79	78	78	78	
8	92	85	80	77	91	84	80	77	83	80	77	82	79	77	82	79	76	75	75	75	
9	89	82	78	75	88	82	78	75	81	77	75	80	77	74	79	76	74	73	73	73	
10	87	80	75	73	86	79	75	73	79	75	72	78	75	72	77	74	72	71	71	71	

Zonal Lumen Summary

0°-10°	10°-20°	20°-30°	30°-40°	40°-50°	50°-60°	60°-70°	70°-80°	80°-90°
268 lm	470 lm	153 lm	15.8 lm	4.54 lm	3.28 lm	4.00 lm	5.01 lm	4.57 lm
90°-100°	100°-110°	110°-120°	120°-130°	130°-140°	140°-150°	150°-160°	160°-170°	170°-180°
0.000 lm	0.000 lm	0.000 lm	0.000 lm	0.000 lm	0.000 lm	0.000 lm	0.000 lm	0.000 lm