



GR-O Series

GRAFFITI

is the innovative line of
LED lighting solutions from
Specialty Lighting Industries.



GRO Series in low to medium ceiling heights typically found in residential, commercial or retail applications. GR-O Series fixtures utilize a wider aperture lens to maximize light spread and minimizing light cut-off. The Graffiti™ fixtures provide cost effective LED lighting solutions. As the creative spirit of its name implies, Graffiti™ systems provide all the quality SLI has grown famous for over the last 25 years, but at reduced lead times, affordable price points and innovative technologies that will liberate your creative flair.

THERMAL MANAGEMENT: Proprietary high performance aluminum black heatsink for maximum LED life

Project Name:

Specifier:

Distributor:

Quantity:

Type:

Signature:

ADJUSTABLE/FIXED SPECIFICATIONS

MOUNTING - Recessed in architectural ceiling. Butterfly brackets and Hanger bars included with housing and mounting pans.

- **RM**- Open fixture for retrofit for remodel in existing ceilings
- **IC**-Housing for new construction where insulation comes in contact with fixture
- **NIC**-Housing for new construction where IC not required
- **NP**- For New construction
- **DP**- Pan for dropped ceilings
- **BP**- Pan for metal studs
- **CP**- Chicago Plenum

HOUSING - C1/C2 Fixed housing is smaller size than Lutron/EldoLED Fixed housing (see page 3 for details)*.

TRIM - One piece die cast aluminum, flanged or flangeless trim with a 1/2" regress bevel and overlap for flange. Available for wet locations. Accommodates up to 1" ceiling thickness as standard.

- **ZT/ZST**- for use in plaster/GWB ceilings
- **FT/FST**- for use in architectural ceilings

ELECTRICAL

- **Standard 0-10v (C1)** Dimming down to 1%
 - **TRIAC/ELV (C2)** Dimming down to 1%
 - **EldoLED 0-10v (E1)** Logarithmic Dimming down to 0.1%
 - **EldoLED Dali (E2)** Dimming down to 0.1%
 - **EldoLED 0-10v (E3)** Linear Dimming down to 0.1%
 - **Lutron Hi-lume (L2)** Hi-lume 1% (former A-Series) 2-wire Driver
 - **Lutron Hi-lume EcoSystem 1% (LTB)** Hi-lume 1% with Fade-to-Black (former H-Series) digital EcoSystem Driver
 - **Lutron Hi-lume Premier 0.1% (LTP)** Hi-lume Premier 0.1% with Fade-to-Black digital EcoSystem
 - **EM Pack** Dimming driver with emergency battery backup
- All drivers are field replaceable*

Specifier/Installer is responsible for testing & validating compatibility of any control equipment used. Additional conductors may be required depending on dimming system.

LED

- **CZ- Citizen** 2700 / 3000 / 3500K / 4000K, 90+CRI, 50+R9
- **AD- Ambient Dim™** 3000 to 1900K / 3000 to 2200K / 2700 to 2200K, 97 CRI
- **XT- Xicato** Available on request



LENS/OPTICS - Interchangeable reflector provides multiple beam patterns. Field-changeable optics

- **Spot (15°)** • **Narrow (24°)** • **Flood (38°)** • **Wide Flood (60°)**
- Optional lenses available for aperture include Solite and Veiling Acrylic. Accepts two optical accessories and an optional trim mounted lens.

FINISH - Black powder paint housing. Aperture trim available in white as standard.

Can be field painted to match ceiling finish.

WARRANTY - 5 year limited on LED and driver. See website for details.

LABELS -  US, US tested to UL standards 1598, Dry/Damp and Wet listings. IC/Airtight,  Supports CA Title 24 part 6 compliance meeting JA8 Requirements in many combinations. Chicago Plenum Available.

Patent Pending. These specifications subject to change without notice. 01/23 Rev.2



INFORMATION- TRIM



ROUND/ FLANGED

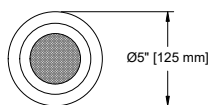

ROUND / FLANGELESS

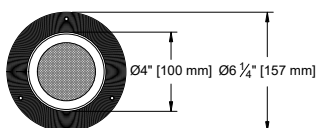

SQUARE / FLANGED

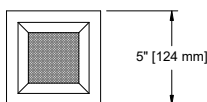

SQUARE / FLANGELESS

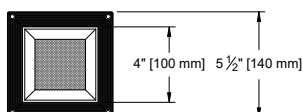

PHOTOMETRICS

*Visit website for
further photometric data
or Click Here

*LED Technology rapidly changes. Please consult factory for
latest specs and photometry.

ORDER INFO

CODE

Graffiti™ Housing

GR-O

Housing

RM = Retrofit
IC = IC/Airtight
NIC = Non IC
NP = New Pan
DP = Dropped Pan
BP = Bracket Pan
CP = Chicago Plenum

Source/System Watts/Delivered lm/LPW(Lumens/watt)

VALUES BASED ON ROUND, FIXED, WITH FLOOD OPTIC

TITLE 24 JAB CZ14 = Citizen 15W / 1190lm / 82LPW
TITLE 24 JAB CZ20 = Citizen 21W / 1587lm / 76LPW
TITLE 24 JAB AD14 = Ambient Dim 15W / 991lm / 66LPW
TITLE 24 JAB AD20 = Ambient Dim 21W / 1636lm / 78LPW (AD 3019 only)
XT = Xicato - Contact Factory

Type

TITLE 24 JAB F = Fixed
TITLE 24 JAB A = Adjustable

CCT

Fixed White Ambient Dim

TITLE 24 JAB 27 = 2700K TITLE 24 JAB 3019 = 3000K to 1900K
TITLE 24 JAB 30 = 3000K TITLE 24 JAB 3022 = 3000K to 2200K (AD14 only)
TITLE 24 JAB 35 = 3500K TITLE 24 JAB 2722 = 2700 to 2200K (AD14 only)
40 = 4000K

Beam

SP = Spot
NF = Narrow flood
FL = Flood
WF = Wide flood

Driver

TITLE 24 JAB C1 = 0-10V dimming, 1%, 120-277v
TITLE 24 JAB C2 = TRIAC/ELV 2-wire, 1% 120V only (Leading/Trailing Edge)
TITLE 24 JAB E1 = EldoLED 0-10V Logarithmic Dim, 0.1%, 120-277v
TITLE 24 JAB E2 = EldoLED DALI, 0.1%, 120-277v
TITLE 24 JAB E3 = EldoLED 0-10V Linear Dim, 0.1%, 120-277v
TITLE 24 JAB L2 = Hi-lume 1% (former A-Series) 2-wire Driver, 120v only (LTEA)
TITLE 24 JAB LTB = Hi-lume 1% with Fade-to-Black (former H-Series) digital EcoSystem Driver, 120-277v (LDE1)
TITLE 24 JAB LTP = Hi-lume Premier 0.1% with Fade-to-Black digital EcoSystem, 120-277v (PEQ0)
EM**= Emergency Pack **Lutron & EldoLED require Inverter

Graffiti™ Trim

GRT-O

Shape

RD = Round
SQ = Square

Trim

FT = Flanged FST* = Flanged Shower
ZT = Flangeless ZST* = Flangeless Shower *Lens Required

Finish

WHT = White

Lens

91A = Solite
79A = Frosted
None

79A / 91A

* [CLICK HERE](#) to view Accessories for Trims.

Patent Pending. These specifications subject to change without notice. 01/23 Rev. 2

1306 Doris Avenue, Ocean, NJ 07712 USA 800.462.7812 | 732.517.0800 FAX 732.517.0971
www.specialty-lighting.com | www.graffitilighting.com

INFORMATION- HOUSING

RETROFIT

For easy installation in existing ceilings.

ADJUSTABLE

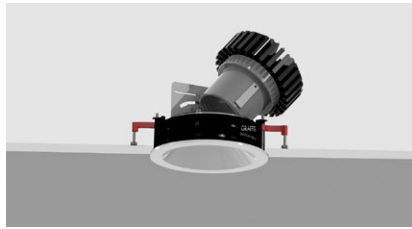

FIXED

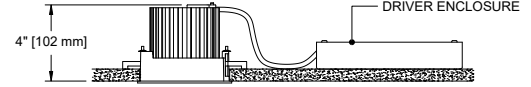
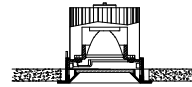
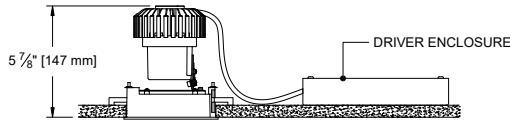
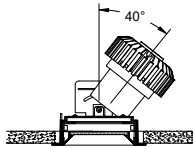

IC/NIC/CP

For projects requiring housings or IC rated fixtures.

1287 Hanger Bars comes standard with fixed and adjustable housing (see below for hanger bar dimensions).

ADJUSTABLE All Drivers

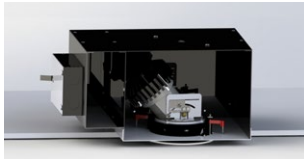

FIXED C1/C2 Drivers



FIXED LUTRON / ELDO Drivers

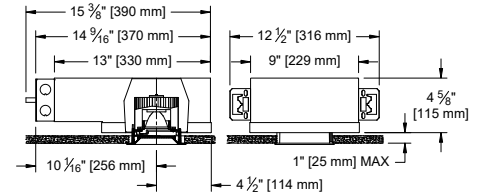
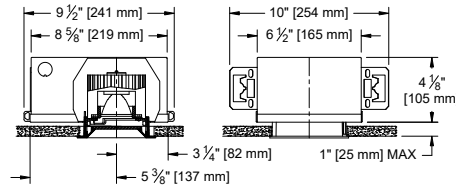
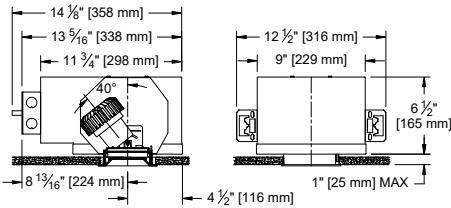

PAN

For new construction applications not requiring a housing.

ADJUSTABLE

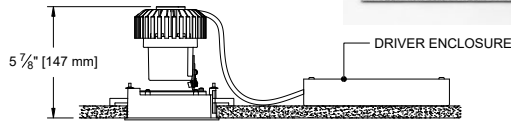
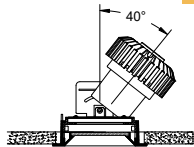

OPTION - New Pan

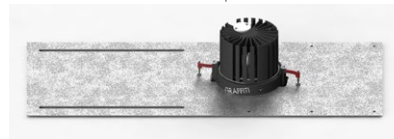

OPTION - Dropped Pan

for use in Armstrong® T-Bar ceilings

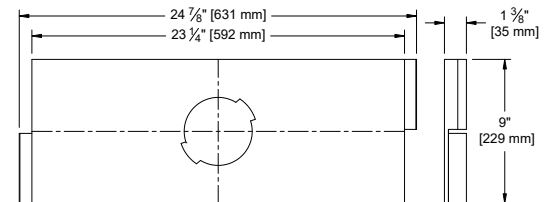
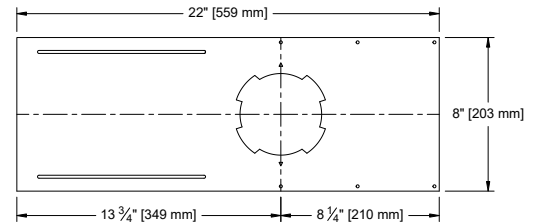

1287 Hanger Bar comes standard with Bracket Pan & IC/NIC
Maximum Extension: 26"

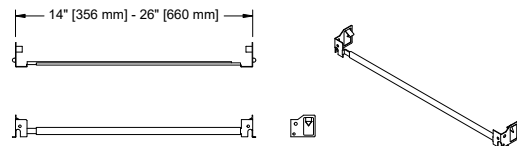

OPTION - Bracket Pan

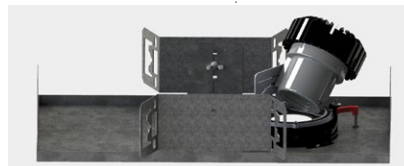

FIXED

