



GR-W Series



is the innovative new line of LED lighting solutions from Specialty Lighting Industries.



GRW Series wallwashing in low to medium ceiling heights typically found in residential, commercial or retail applications. The wall wash fixture creates consistent and even illumination from ceiling down using our proprietary Supertex™ lens. Fixture provided with LED positioned for optimal performance. The Graffiti™ fixtures provide cost effective LED lighting solutions. As the creative spirit of its name implies, Graffiti™ systems provide all the quality SLI has grown famous for over the last 25 years, but at reduced lead times, affordable price points and innovative technologies that will liberate your creative flair.

THERMAL MANAGEMENT: Proprietary high performance aluminum black heatsink for maximum LED life

Project Name:

Specifier:

Distributor:

Quantity:

Type:

Signature:

WALL WASHER

SPECIFICATIONS

MOUNTING - Recessed in architectural ceiling. Butterfly brackets and Hanger bars included with housing and mounting pans.

- **RM**- Open fixture for retrofit for remodel in existing ceilings
- **IC**- Housing for new construction where insulation comes in contact with fixture
- **NIC**- Housing for new construction where IC not required
- **NP**- For New construction
- **DP**- Pan for dropped ceilings
- **BP**- Pan for metal studs
- **CP**- Chicago Plenum

HOUSING - C1/C2 Fixed housing is smaller size than Lutron/EldoLED Fixed housing (see page 3 for details)*.

TRIM - Die cast aluminum, flanged or flangeless trim with a regress bevel and overlap for flange. Available for wet locations. Accommodates up to 1" ceiling thickness as standard.

- **ZT**- for use in plaster/GWB ceilings
- **FT/FST**- for use in architectural ceilings

ELECTRICAL

- **Standard 0-10v (C1)** Dimming down to 1%
 - **TRIAC/ELV (C2)** Dimming down to 1%
 - **EldoLED 0-10v (E1)** Logarithmic Dimming down to 0.1%
 - **EldoLED Dali (E2)** Dimming down to 0.1%
 - **EldoLED 0-10v (E3)** Linear Dimming down to 0.1%
 - **Lutron Hi-lume (L2)** Hi-lume 1% (former A-Series) 2-wire Driver
 - **Lutron Hi-lume EcoSystem 1% (LTB)** Hi-lume 1% with Fade-to-Black (former H-Series) digital EcoSystem Driver
 - **Lutron Hi-lume Premier 0.1% (LTP)** Hi-lume Premier 0.1% with Fade-to-Black digital EcoSystem
 - **EM Pack** Dimming driver with emergency battery backup
- All drivers are field replaceable*

Specifier/Installer is responsible for testing & validating compatibility of any control equipment used. Additional conductors may be required depending on dimming system.

LED

- **CZ- Citizen** 2700-4000K, 90+CRI
- **AD- Ambient Dim™** 3000-1900K, 97 CRI
- **XT- Xicato** 2700-4000K, 90+ CRI

LENS/OPTICS - Supertex borosilicate spread lens, hinged for relamping. Alzak kick reflector.

FINISH - Black powder paint housing. Aper. trim available in white as standard. Can be field painted to match ceiling finish.

WARRANTY - 5 year limited on LED and driver. See website for details.

LABELS -  US tested to UL standards 1598, Dry/Damp and Wet listings. IC/Airtight,  compliant,  compliant. Chicago Plenum Available.

Patent Pending. These specifications subject to change without notice. 12/19



INFORMATION- TRIM



ROUND/ FLANGED

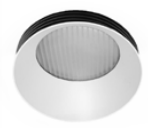

ROUND / FLANGELESS

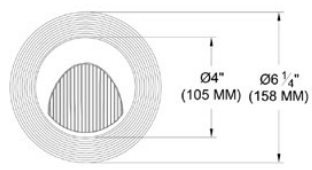

SQUARE / FLANGED

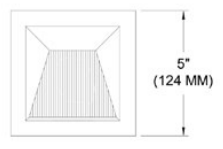

SQUARE / FLANGELESS

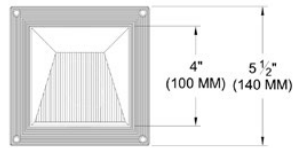

PHOTOMETRICS

***Visit website for further photometric data or Click Here**

*LED Technology rapidly changes. Please consult factory for latest specs and photometry.

ORDER INFO **CODE**

Graffiti™ Housing **GRW**

Housing

RM = Retrofit*
IC = IC
NIC = Non IC
NP = New Pan*
DP = Dropped Pan*
BP = Bracket Pan*
CP = Chicago Plenum

*** Consult factory for Xicato**

Source/Wattage/Lumens/Delivered

AD14 = Ambient Dim™ / 14.5W / 1000lm / 475lm
CZ14 = Citizen / 14W / 1640lm / 574lm
CZ20 = Citizen / 20W / 2265lm / 786lm
XT8 = Xicato / 8W / 800lm / 440lm
XT12 = Xicato / 12W / 1055lm / 580lm
XT17 = Xicato / 17W / 1400lm / 817lm

Type **WW**

WW = Wall Wash **C1/C2** Fixed Housing is smaller size than Lutron / Eldo LED Fixed Housing (See page 3 for Details)*

CCT

27 = 2700K
30 = 3000K
35 = 3500K
40 = 4000K
AD = 3000K-1900K

Driver

C1 = 0-10V dimming, 1%, 120-277v
C2 = TRIAC/ELV 2-wire, 1% 120V only (Leading/Trailing Edge)
E1 = EldoLED 0-10V Logarithmic Dim, 0.1%, 120-277v
E2 = EldoLED DALI, 0.1%, 120-277v
E3 = EldoLED 0-10V Linear Dim, 0.1%, 120-277v
L2 = Hi-lume 1% (former A-Series) 2-wire Driver, 120v only (LTEA)
LTB = Hi-lume 1% with Fade-to-Black (former H-Series) digital EcoSystem Driver, 120-277v (LDE1)
LTP = Hi-lume Premier 0.1% with Fade-to-Black digital EcoSystem, 120-277v (PEQ0)
EM** = Emergency Pack **Lutron & EldoLED require Inverter

Graffiti™ Trim **GRTW**

Shape

RD = Round
SQ = Square

Trim

FT = Flanged
ZT = Flangeless
FST* = Flanged Shower

Finish **WHT**

WHT = White

Lens **82A**

82A = Frosted Supertex

[* CLICK HERE to view Accessories for Trims.](#)

INFORMATION- HOUSING

RETROFIT

For easy installation in existing ceilings.

SQUARE / FLANGE



ROUND / PLASTER FLANGE

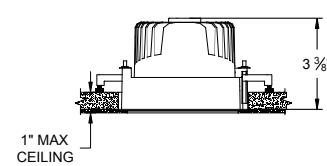
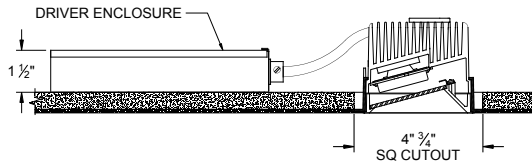
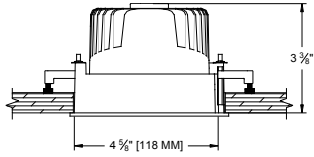
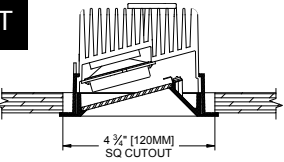

IC/NIC/CP

For projects requiring housings or IC rated fixtures.

1287 Hanger Bars comes standard with fixed and adjustable housing (see below for hanger bar dimensions).

FIXED C1/C2 Drivers



FIXED LUTRON / ELDO Drivers

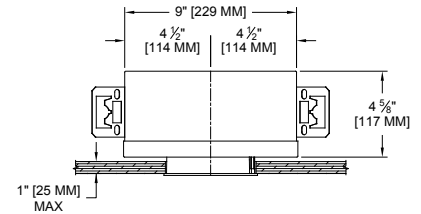
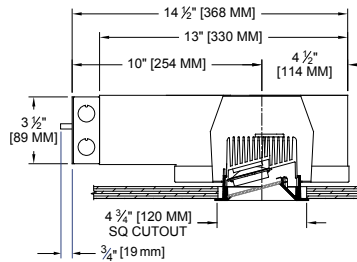
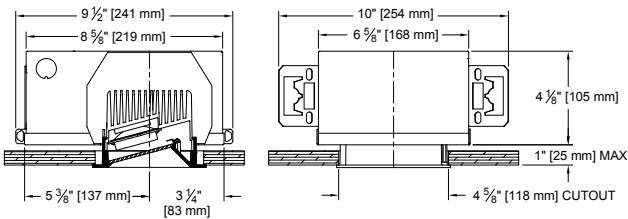

PAN

For new construction applications not requiring a housing.

OPTION - New Pan

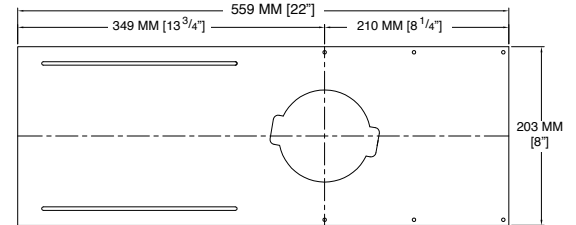

OPTION - Dropped Pan

for use in Armstrong® T-Bar ceilings

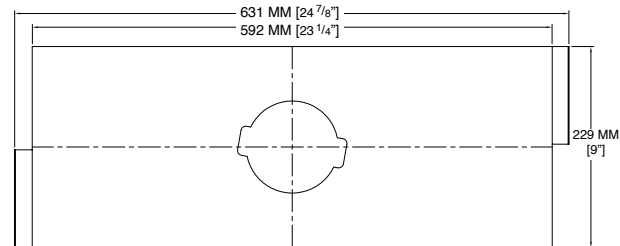
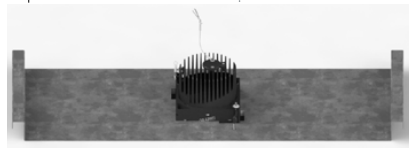

1287 Hanger Bar comes standard with Bracket Pan & IC/NIC
Maximum Extension: 26"

OPTION - Bracket Pan

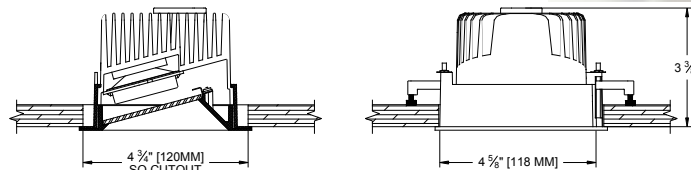
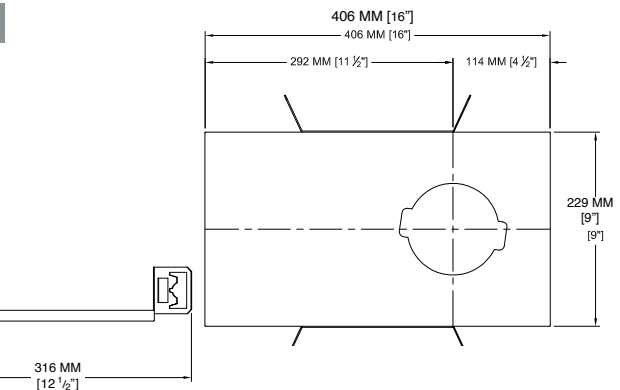
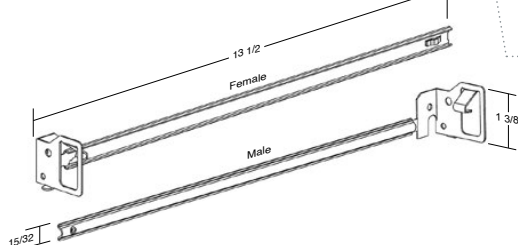

1" HEIGHT ADJUSTMENT

Patent Pending. These specifications subject to change without notice. 7/18