

**Project Name:**

**Specifier:**

**Distributor:**

**Quantity:**

**Type:**

**Signature:**

## GR-W Series



LED

Lighting

Solutions

**GRW** Series wallwashing in low to medium ceiling heights typically found in residential, commercial or retail applications. The wall wash fixture creates consistent and even illumination from ceiling down using our proprietary Supertex™ lens. Fixture provided with LED positioned for optimal performance. The Graffiti™ fixtures provide cost effective LED lighting solutions. As the creative spirit of its name implies, Graffiti™ systems provide all the quality SLI has grown famous for over the last 25 years, but at reduced lead times, affordable price points and innovative technologies that will liberate your creative flair.

**THERMAL MANAGEMENT:** Proprietary high performance aluminum black heatsink for maximum LED life

## WALL WASHER

### SPECIFICATIONS

**MOUNTING** - Recessed in architectural ceiling. Butterfly brackets and Hanger bars included with housing and mounting pans.

- **RM**- Open fixture for retrofit for remodel in existing ceilings
- **IC**- Housing for new construction where insulation comes in contact with fixture
- **NIC**- Housing for new construction where IC not required
- **NP**- For New construction
- **DP**- Pan for dropped ceilings
- **BP**- Pan for metal studs
- **CP**- Chicago Plenum

**HOUSING** - C1/C2 Fixed housing is smaller size than Lutron/EldoLED Fixed housing [See Details on Pg 3](#)

**TRIM** - Die cast aluminum, flanged or flangeless trim with a regress bevel and overlap for flange . Available for wet locations.

\*Accommodates up to 1" ceiling thickness as standard.

- **ZT**- for use in plaster/GWB ceilings
- **FT/FST**- for use in architectural ceilings

Extension Clips available upon request (TEX2)

### ELECTRICAL

- **Standard 0-10v (C1)** Dimming down to 1%
- **TRIAC/ELV (C2)** Dimming down to 1%
- **0-10v (E1)** Logarithmic Dimming down to 0.1%
- **Dali-2 (E2)** Dimming down to 0.1%
- **0-10v (E3) Linear Dimming down to 0.1%**
- **Lutron Hi-lume EcoSystem 1% (LTB)** Hi-lume 1% with Fade-to-Black (former H-Series) digital EcoSystem Driver
- **TruPhase™ (TR2)** 2 wire Phase Dimming down to 0.1% \*available up to 20W (compatibile with forward and reverse phase dimmers)
- **EM Pack** Dimming driver with emergency battery backup  
All drivers are field replaceable\*

Specifier/Installer is responsible for testing & validating compatibility of any control equipment used. Additional conductors may be required depending on dimming system.

### LED



- **CZ- Citizen** 2400K / 2700k / 3000 / 3500K / 4000K, 90+CRI, 50+R9
- **AD- Ambient Dim™** 3000 to 1900K / 3000 to 2200K / 2700 to 2200K, 97 CRI

**LENS/OPTICS** - Supertex borosilicate spread lens, hinged for relamping.

[View Lens Guide](#)

**FINISH** - Black powder paint housing. Aperture trim available in white, black and silver as standard. White recommended for field paint matching.

**WARRANTY** - 5 year limited on LED and driver. [View Terms and Conditions](#)

**LABELS** -  US tested to UL standards 1598, Dry/Damp and Wet listings. IC/Airtight,  Supports CA Title 24 part 6 compliance meeting JAS Requirements in many combinations. Chicago Plenum Available.

ALL ELECTRICAL COMPONENTS AND REPLACEMENT PART ARE ACCESSABLE FOR ROOM SIDE MAINTENANCE.

**ORDER INFO**

**CODE**

Graffiti™ Housing

**GRW**

**Housing**

- RM = Retrofit
- IC = IC/Airtight
- NIC = Non IC
- NP = New Pan
- DP = Dropped Pan
- BP = Bracket Pan
- CP = Chicago Plenum

**Source/System Watts/Delivered lm**

- CZ14** = Citizen 14W / 813lm / 58LPW
- CZ20** = Citizen 21W / 1102lm / 53 LPW
- CZY** = Citizen 21W / 1318lm / 63LPW
- AD14** = Ambient Dim 15W / 526lm / 35 LPW
- AD20** = Ambient Dim 21W / 826lm (AD 3019 only) / 36LPW  
Based on Round. AD based on 3019 at 3k.  
(See Photometrics tab on website for other values.)

**Type**

- WW** = Wall Wash

**CCT**

- |                    |  |
|--------------------|--|
| <b>Fixed White</b> | <b>Ambient Dim</b>                       |
| <b>24</b> = 2400K  | <b>3019</b> = 3000K to 1900K             |
| <b>27</b> = 2700K  | <b>3022</b> = 3000K to 2200K (AD14 only) |
| <b>30</b> = 3000K  | <b>2722</b> = 2700 to 2200K (AD14 only)  |
| <b>35</b> = 3500K  |  |
| <b>40</b> = 4000K  |  |

**Driver** \*\*Lutron & EldoLED require Inverter

- C1** = 0-10V dimming, 1%, 120-277v
- C2** = TRIAC/ELV 2-wire, 1% 120V only (Leading/Trailing Edge)
- E1** = 0-10V Logarithmic Dim, 0.1%, 120-277v
- E2** = DALI-2, 0.1%, 120-277v
- E3** = 0-10V Linear Dim, 0.1%, 120-277v
- LTB** = Hi-Lume 1% with Fade-to-Black (former H-Series) digital EcoSystem
- TR2** = 2 wire Phase Dimming down to 0.1% - Linear/Logarithmic Driver, 120-277v (LDE1)
- EM** = Emergency Pack
- C1-EM** = C1 Emergency Pack (0-10V dimming, 1%, 120-277v)
- C2-EM** = C2 Emergency Pack (TRIAC/ELV 2-wire, 1% 120V only (Leading/Trailing Edge))

**Graffiti™ Trim**

**GRTW**

**Shape**

- RD = Round
- SQ = Square

**Trim**

\*Lens Required

- FT** = Flanged
- FST\*** = Flanged Shower
- TEX2** = Extension Clips
- ZT** = Flangeless
- ZST\*** = Flangeless Shower

**Finish**

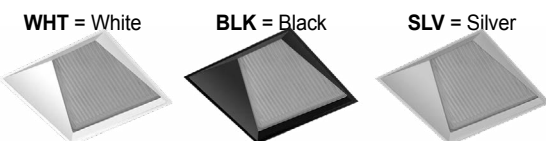
- WHT** = White
  - BLK** = Black
  - SLV** = Silver
- 

**Lens**

**82A**

**82A** = Frosted Supertex

**INFORMATION- TRIM**



**ROUND / FLANGED**

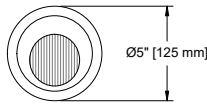

**ROUND / FLANGELESS**

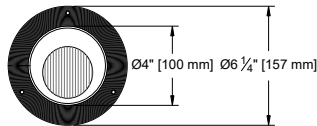

**SQUARE / FLANGED**

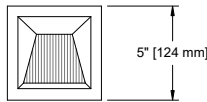

**SQUARE / FLANGELESS**

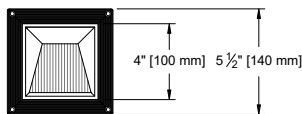

**Photometrics**

[View additional photometric data](#)

\*LED Technology rapidly changes. Please consult factory for latest specs and photometry.

**Care & Maintenance**

**\*\*LED's are sensitive electronic components and should be protected from dust and debris during the installation and maintenance process.**

[Read Fixture Care & Maintenance Guidelines](#)

**Lens Guide**

[View Lens Guide](#)

# INFORMATION- HOUSING

RETROFIT

For easy installation in existing ceilings.

SQUARE / FLANGE



ROUND / PLASTER FLANGE

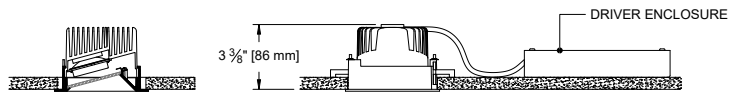

IC/NIC/CCP

For projects requiring housings or IC rated fixtures.

1287 Hanger Bars comes standard with fixed and adjustable housing (see below for hanger bar dimensions).

FIXED C1/C2 Drivers, EldoLED, TruPhase™



FIXED LUTRON

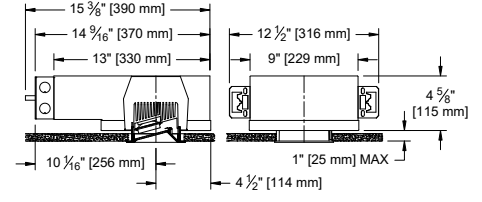
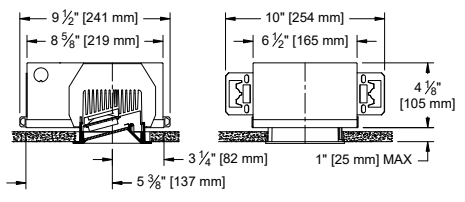

PAN

For new construction applications not requiring a housing.

OPTION - New Pan

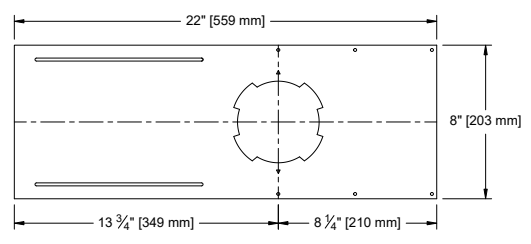

OPTION - Dropped Pan  
for use in Armstrong® T-Bar ceilings

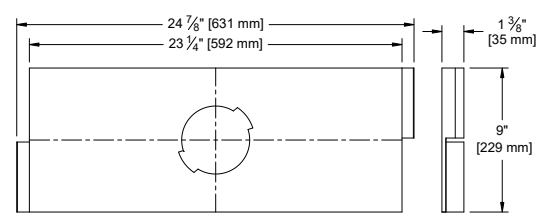
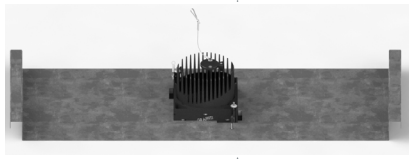

1287 Hanger Bar comes standard with Bracket Pan & IC/NIC

Maximum Extension: 26"

OPTION - Bracket Pan

