

CAUTIONS AND WARNINGS:

1. This product *must* be installed in accordance with the applicable installation code by a licensed electrician familiar with the construction and operation of the product and hazards involved.
2. Power *must* be **OFF** when connecting the fixture. "Hot plugging" the light engine and driver will damage the LED source.
3. The light engine is low voltage and is factory wired to the driver.
DO NOT CONNECT LIGHT ENGINE TO THE BUILDING AC POWER.

DISCLAIMER: Screw and hardware on the outer edge of adjustable head are **NOT** to be tampered with. ANY adjustment **WILL VOID** warranty.

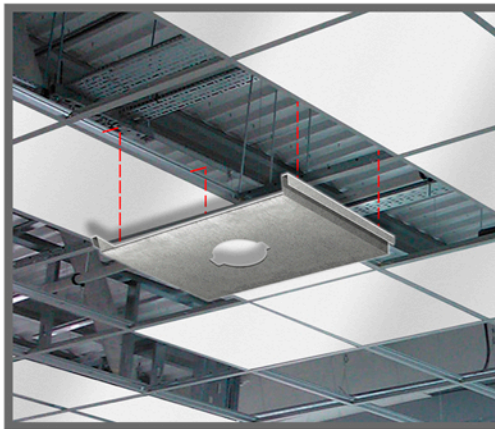

A Slide dropped pan over metal rails of suspended ceiling. Dropped pan can be used as a template, lay pan on top of tile, position and draw shape onto tile for cutout.



B Make sure dropped pan has enough clearance beneath the ceiling for tile install. Tile slides in underneath dropped pan.

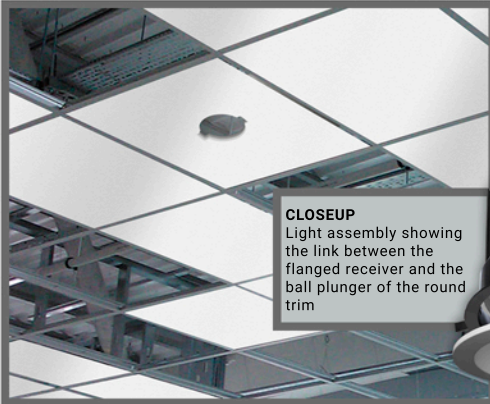

CLOSEUP
Light assembly showing the link between the flanged receiver and the ball plunger of the round trim

C Check to see that dropped pan is resting securely on top of tile rails. Any gap between pan and rail can create instability.



TOP VIEW

D Once receiver is secured, connect all wiring and slide driver enclosure with light assembly through cutout.



E Align ball plungers on light assembly to top holes on receiver. Driver enclosure can rest on top of dropped pan.

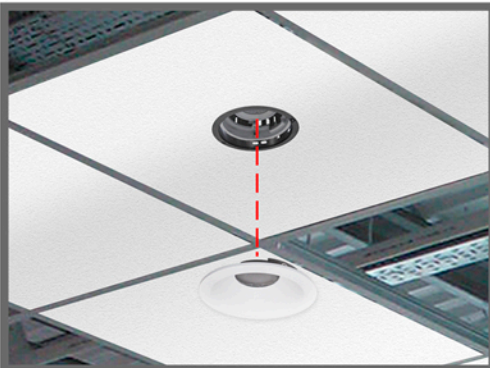

F Finalize install by locking trim into the secured light assembly.

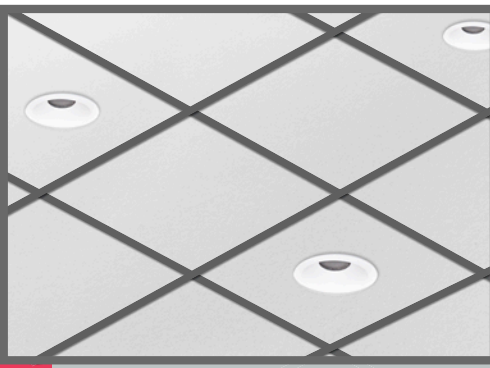

G Repeat process for all tiling elements that require a light assembly

How to secure with safety cables?



Installation Instructions for Dropped Pan Round Flanged Trim GRF, GR, GRO, GRW

TRIMS AVAILABLE

